

ANTIGRAVITY BATTERIES

POWER STATION PS-45

USER MANUAL



CONTENTS:

WELCOME	
SAFETY & MAINTENANCE	
I PRODUCT OVERVIEW	Page 1
2 KIT CONTENTS	Page 2
3 PRODUCT SPECS	
4 TURNING ON THE UNIT	Page 3
5 USING AC/DC POWER	
6 FAULT INDICATOR LIGHTS	
7 CHARGING THE PS45	Page 4
8 TURNING ON THE LED LIGHT	
9 WARRANTY	Page 5
10 REGISTRATION	Page 6
II CONTACT INFO	



Welcome

THANK YOU

Thank you for purchasing the Antigravity Batteries PS45 Power Station. The PS45 is an extremely compact, lightweight Lithium-Ion Personal Power Station that offers a best-in-class 45,000mah (166 Watt Hours) of Capacity. You can use the PS45 to Charge or Power your electronics, such as any USB Devices, 12v Devices, Laptop Computers, Camp Lighting and much more with its wide variety of output ports.

The PS45 can also be conveniently charged with the provided Wall Charger or optional Solar Charging Panels (see our website antigravitybatteries.com). You will find our Powerstation products are perfect for camping, powering your electronics around your house, or as a convenient back-up power supply in the event of a power outage. They also have a convenient built-in Light.

This PS45 supports 12v DC, Quick-Charge USB, and AC output up to 100w continuous for extreme flexibility in use. We will also be offering larger units for higher energy demands.

Please read this User's Manual fully before using this product.

For more information feel free to Contact us.

info@antigravitybatteries.com
antigravitybatteries.com
themicrostart.com
310 527 2330

Antigravity Batteries
15622 Broadway Center St.
Gardena CA
90248



Safety & Maintenance



SAFETY

- 1) Do not short-circuit the device; store in a cool, dry area. Avoid storing the device together with metal objects such as coins, jewelry, keys, etc.
- 2) Do not heat the device or put it into a fire, water or other liquids.
- 3) Do not expose to high temperatures, including direct sunlight.
- 4) Do not place the device in a highly humid, dusty environment.
- 5) Do not disassemble the device; no User-Serviceable parts.
- 6) Do not drop, or crush, or place heavy objects on the product.
- 7) Do not place this product in an area allowing access to those with lack of experience or knowledge about use of this product.
- 8) Do not allow children to play with this product; it can produce high voltage resulting from playing with it.
- 9) Do not cover the product with towels, clothes and other items when using. This can cause over-heating and failure of the unit resulting in Fire or Property Damage.
- 10) Product may be warm when charging, which is normal. Please be careful when handling. Discontinue use if HOT.
- 11) Please deal with the disposal of Battery products according to the regulations, and do not put batteries into household garbage. Take to a local battery/electronics recycling center.
- 12) Use this product only as intended to avoid electric shock.

ONLY USE THE PROVIDED A/C CHARGER. Do not use other Wall Chargers to charge this product!



MAINTENANCE

- 1) In order to avoid interference, please keep away from TV, radio and other devices when charging.
- 2) If you will not be using the PS45 for a long time, please disconnect the cable and then store it in cool dark place.
- 3) Remember to turn off the AC Power when not in use.
- 4) In order to extend the life of the product (lithium battery), it is best to charge it once in 3 months or at least once every 5 months minimum.

RECYCLING

Be sure to deliver discarded electronics, batteries, and packaging materials to special recycling centers. Do not dispose of in Trash. This can help handle uncontrolled waste and promote material recovery.

WARRANTY INFORMATION

The PS45 has a 1 year warranty. You must register your product within 30 days of purchase; you can register online at our [Registration](#) page.



Product Overview

BACK

FRONT



- 1** QC USB OUTPUTS
- 2** DC OUTPUTS (12V)
- 3** CHARGER INPUT
- 4** AC OUTPUT
- 5** ON/OFF BUTTON
- 6** CAPACITY INDICATORS

- 7** ERROR INDICATOR
- 8** AC POWER INDICATOR
- 9** AC ON/OFF BUTTON
- 10** LED LIGHT BUTTON
- 11** LED LIGHT

Learn more on pages 3-4

Kit Contents



AC CHARGER PS-45 PORTABLE POWER STATION

(Can also be charged with optional Solar Panels such as the Antigravity XS-60 and XS-100)

Specifications

BATTERY: Lithium-Ion	USB OUTPUTS: Dual USB (QC3.0) 5V\9V 2.1A
CAPACITY: 45000mAh(3.7V) 166Wh	DC OUTPUTS: DC1+DC2 9-12.5V/10A (Max) 5.5mm
SIZE (LWH): 6.3 x 3 x 6 in (160x75x150mm)	AC OUTPUT: 100-110V/60Hz
WEIGHT: about 2.86 lbs (1.30Kg)	AC POWER: AC Continuous output power: 100W AC Peak power: 200W (2 second max)
WALL CHARGING: DC 5.5mm Tip @ 15V/2A	CAPACITY INDICATOR: 4-LED display (25%-100%)
SOLAR CHARGING: DC 5.5mm Tip @ 18V (*Optional; Solar Panel Not Included)	TEMPERATURE RANGES: Storage: -4°F-113°F (-20°C-45°C) Operation: -4°F-104°F (-20°C-40°C) Charging: 32°F-104°F (0°C-40°C)
CHARGING TIME: Standard (15V/2A): 6-8 Hrs	
LIGHTING TIME: 166 Hrs, 1W on-board LED	BATTERY MANAGEMENT SYSTEM (BMS): Overload, overvoltage, overcharge, overcurrent, overpower, short-circuit Protections
CYCLE LIFE: >500	

Product Use



TURNING ON PS45 & CHECKING AVAILABLE CAPACITY

- 1) Press the Power Button; the Blue LED Indicators light up to display the currently available capacity of the PS45, and the DC outputs turn on. The PS45 must be "ON" to charge/power Devices. Each indicator light lit is equal to 25% capacity. The unit will Automatically shut off if nothing is being charged.
- 2) To use the AC Output Port, first press the Power Button to turn on the unit, then press the AC Button to turn on the AC Port; a small Green LED Indicator will light up, indicating "ON" status of AC Power. To turn off the AC output, press the AC Button again.

NOTE:

Please remember to TURN OFF the AC Button if not using AC; unnecessary battery drain will occur if the AC is left "ON" and nothing is being charged.



USING AC/DC POWER

To use the DC Ports please turn on the PS45 as described earlier. When the unit is ON, all the USB and DC 12v Outputs will be ready to use. Simply plug in your Device. The DC 12v Outputs use a 5.5mm DC plug which is standard on most 12v Electronics. If other adapters are needed, contact your local electronics store.

To use the AC Port please turn on the PS45 as described earlier. Then press the AC Button to activate the AC Port. The AC Port can provide 100w of Power to your device. A Green LED Indicator light will turn on if the AC Port is "ON". Simply plug in your Device at this time.

Remember to Turn Off the AC when not in use; excessive battery drain will occur.

WARNING:

Please note that the Power Output of the A/C Port is limited to 100w continuous power. Usage above this Wattage output will cause the unit to suspend operation. Please ensure your Device does not draw more wattage than this unit provides.



FAULT/ERROR INDICATOR LIGHTS

The common faults that might be seen if a Device is not working well with the PS45 are indicated below.

- Red LED light flashes 2 times, turns off for 2 seconds, and keeps looping.
This is an overcurrent protection fault. Indicates something is drawing more power than the PS45 has.
- Red LED light flashes 3 times, turns off for 2 seconds, and keeps looping indicates overvoltage protection.
This will indicate too much voltage is coming in from the Charger. Correct with lower voltage.
- Red LED light flashes 3 times, turns off for 2 seconds, and keeps looping with over-temperature protection.
This would indicate the unit is getting too hot. Remove from direct Sunlight or discontinue use.
- Red LED is always on which indicates the exhaust is covered or stuck.
Remove obstruction from exhaust fan. Fan must be allowed to cool the PS45.





CHARGING THE PS-45

On the front panel of the PS45 is an "INPUT" Port. This is where you can charge the PS45 by the Provided AC Wall Charger, or by using our optional Antigravity Batteries Solar Panels or other compatible solar panels.

- 1) For AC Charging simply plug in the Wall charger to a 110v Receptical and plug the Charging Tip into the Input Port located on the Front Panel of the PS45. **ONLY USE THE PROVIDED AC CHARGER. DO NOT USE ANY OTHER!**
- 2) For Solar Charging simply plug the Charging Tip from the Solar Panel into the Input Port (5.5mm size) of PS45.

The Blue LED Capacity lights will flash when charging. As the battery charge level increases, each successive LED will light up. When battery is fully charged all 4 LEDs stop flashing and will be fully lit.

LED INDICATOR LIGHTS	STATUS DESCRIPTION
All 4 Blue LED lights ON	Fully Charged
Blue LED lights flashing	Charging in progress
Blue LED lights are always on	Charging is completed
Green LED light is always on	AC Power is ON. Remember to turn Off when AC power is not in use. Substantial battery drain will occur.



TURNING ON THE LED LIGHT

To turn on the Flashlight, press the button on the rear of the unit next to the light. The first press will turn on the light and be a solid light, second press will be a "fast flashing" light, third press will be a "slow flashing" light, and fourth press will turn off the flashlight.

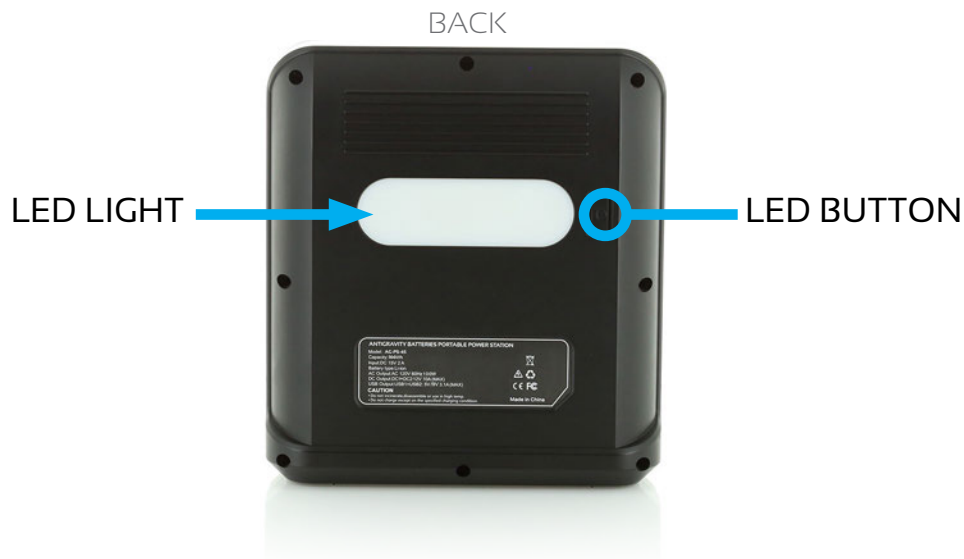

Limited Warranty (Non-Transferable)

1 WARRANTY PERIOD

Antigravity Batteries LLC (ANTIGRAVITY) warrants that its products (the "Product") will be free from defects in material and workmanship for a period of one (1) year from the date of purchase (the "Warranty Period"). For defects reported during the Warranty Period, ANTIGRAVITY will, at its discretion, and subject to ANTIGRAVITY's technical support analysis, replace the product. Replacement parts and products will be new or serviceably used, comparable in function and performance to the original part and warranted for the remainder of the original Warranty Period.

THE FOREGOING LIMITED WARRANTY IS IN LIEU OF AND EXCLUDES ALL OTHER WARRANTIES NOT EXPRESSLY SET FORTH HEREIN, WHETHER EXPRESS OR IMPLIED BY OPERATION OF LAW OR OTHERWISE, INCLUDING, BUT NOT LIMITED TO, ANY IMPLIED WARRANTIES OF MERCHANTABILITY OR FITNESS FOR A PARTICULAR PURPOSE. ANTIGRAVITY'S LIABILITY UNDER THIS LIMITED WARRANTY IS EXPRESSLY LIMITED TO REPLACEMENT (IN THE FORM AND UNDER THE TERMS ORIGINALLY SHIPPED), WHETHER SUCH CLAIMS ARE FOR BREACH OF WARRANTY OR FOR NEGLIGENCE. ANTIGRAVITY SHALL NOT BE LIABLE FOR ANY INCIDENTAL, CONSEQUENTIAL, OR SPECIAL LOSSES, DAMAGES OR EXPENSES OF ANY KIND, INCLUDING, WITHOUT LIMITATION, ANY SUCH LOSSES, DAMAGES, OR EXPENSES ARISING DIRECTLY OR INDIRECTLY FROM THE SALE, HANDLING, OR USE OF THE PRODUCT FROM ANY OTHER CAUSE RELATING THERETO, OR FROM PERSONAL INJURY OR LOSS OF PROFIT.

Some states, provinces and countries do NOT allow the exclusion or limitation of incidental or consequential damages or length of an implied warranty so the above limitation(s) or exclusion(s) may NOT apply. This Limited Warranty gives you specific legal rights and you may also have other legal rights, which vary by state, province and country.

2 LIMITED WARRANTY & CLAIMS

This Limited Warranty is made to the original purchaser from ANTIGRAVITY and does NOT extend to any other person or entity and is NOT assignable; a Warranty Claim is the obligation of the original purchaser.

THIS LIMITED WARRANTY IS VOID UNDER THE FOLLOWING CONDITIONS:

- 1) The Product was not purchased from an Authorized Dealer.
- 2) The original purchaser fails to register the Product within 30 days of purchase.
- 3) The Product is misused, subjected to careless handling, or operated under conditions of extreme temperature, shock, or vibration beyond ANTIGRAVITY's recommendations for safe and effective use.
- 4) The Product has NOT been installed, operated, or maintained in accordance with approved procedures.
- 5) The Product is disassembled, altered, or repaired by anyone, except ANTIGRAVITY.
- 6) The electrical connections to the USB, DC, AC outputs or input port of the Product are modified without the express written consent of ANTIGRAVITY.
- 7) The Product is subject to improper storage or accident.
- 8) The Product is charged by any other charger than supplied or approved by ANTIGRAVITY.
- 9) The Product has been used outside its intended use.



Limited Warranty (Continued)

3 WARRANTY DOES NOT COVER

- 1) Normal wear and tear.
- 2) Cosmetic damage that does NOT affect functionality.

4 WARRANTY CLAIM

The Limited Warranty is void either by elapsed time from date of purchase or from the conditions listed earlier in this document. For a Warranty Claim, it is the obligation of the original purchaser to:

- 1) Complete the Warranty Claim Form; you can download the PDF version from our [Warranty](#) page.
- 2) Forward the Product, including Claim Form and Proof of Purchase, to:

Antigravity Batteries, Attn: Warranty Department
15622 Broadway Center St. Gardena, CA 90248

COSTS OF TRANSPORTING PRODUCTS TO ANTIGRAVITY FOR WARRANTY SERVICE IS THE RESPONSIBILITY OF THE ORIGINAL PURCHASER.



REGISTERING YOUR PS-45

You **MUST** register your ANTIGRAVITY PS-45 product in order to validate the Limited Warranty. You can register the product Online; please visit our [Registration](#) page and submit the requested information.

Contact Us

When you need help or have questions, our knowledgeable support team is here for you! Please feel free to call us during our Office Hours 7:30am-4pm Pacific Time, Monday-Friday; or you can write to us any time!

310 527 2330

Info@AntigravityBatteries.com

15622 Broadway Center St.
Gardena CA 90248

VISIT OUR WEBSITES FOR MORE COOL PRODUCTS, ACCESSORIES AND INFO

ANTIGRAVITYBATTERIES.COM

THEMICROSTART.COM

